

Installation Guide



Need help ?
support@agflo.io
tel:1-855-951-2884

Tools Required

1. Measuring Tape and a Laser Distance Measurer

For bin measurements

2. Torx T20 Screwdriver

To open the unit

3. Smartphone

To configure the device

4. Security Leash

To prevent the device from falling into the bin during the installation

*** Any security devices or harness to prevent falls and injuries during the climb**



Six Steps Installation

1. Installation Startup
2. Battery Connection
3. Device Installation
4. Bin Registration
5. Bin Measurement
6. Activation

If you need help, please contact the AgFlo team

support@agflo.io
1-855-951-2884

1. Installation Startup



1. Scan the Installation QR code located on the side of the sensor.

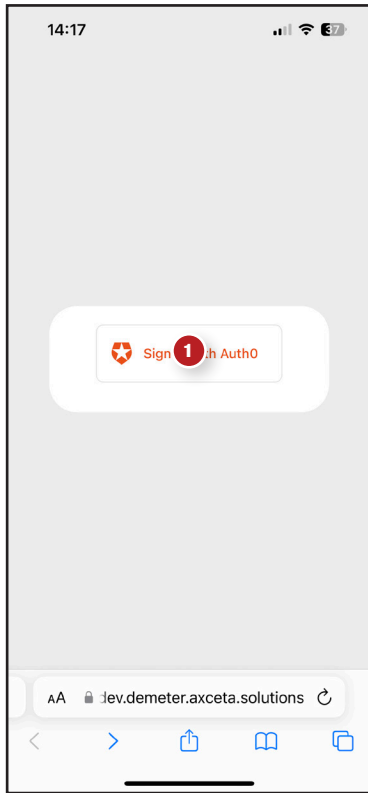

Authentication

1. Click to authenticate. you can access the installation page with this link : <https://installation.agflo.io>

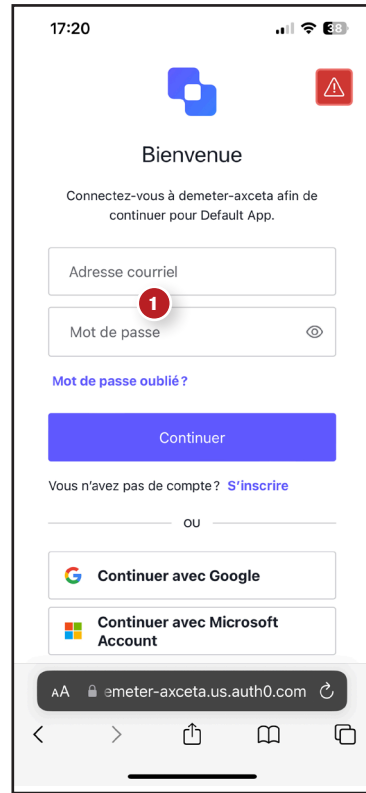

1. Enter the ID and password supplied by the AgFlo team.

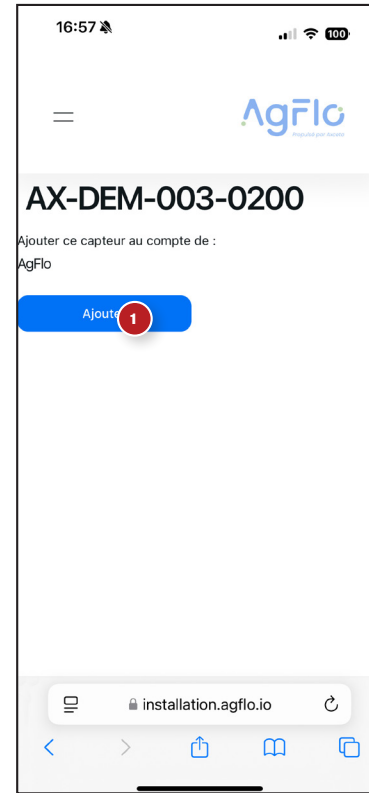

1. Click on "ajouter" to add the device to your account.



1. Click on "Débuter l'installation".

This action is not mandatory, but facilitates the validation of the network connection. It forces the unit to connect repetitively to the network for 15 min.

Once the installation mode enabled, this mention will show up.

Mode installation activé

2. Battery Connection

- Loosen the lid screws and turn the lid counterclockwise to remove it.
- Flip the battery pack upside down to expose the battery connectors and attach the blue connector to the battery pack.
- Make sure you see the LEDs turn on after a few seconds. This will confirm that the unit is powered on.
- To put the lid back in place, align the tabs, engage the lid tabs under the screws and tighten the screws (recommended torque: 2 Nm).

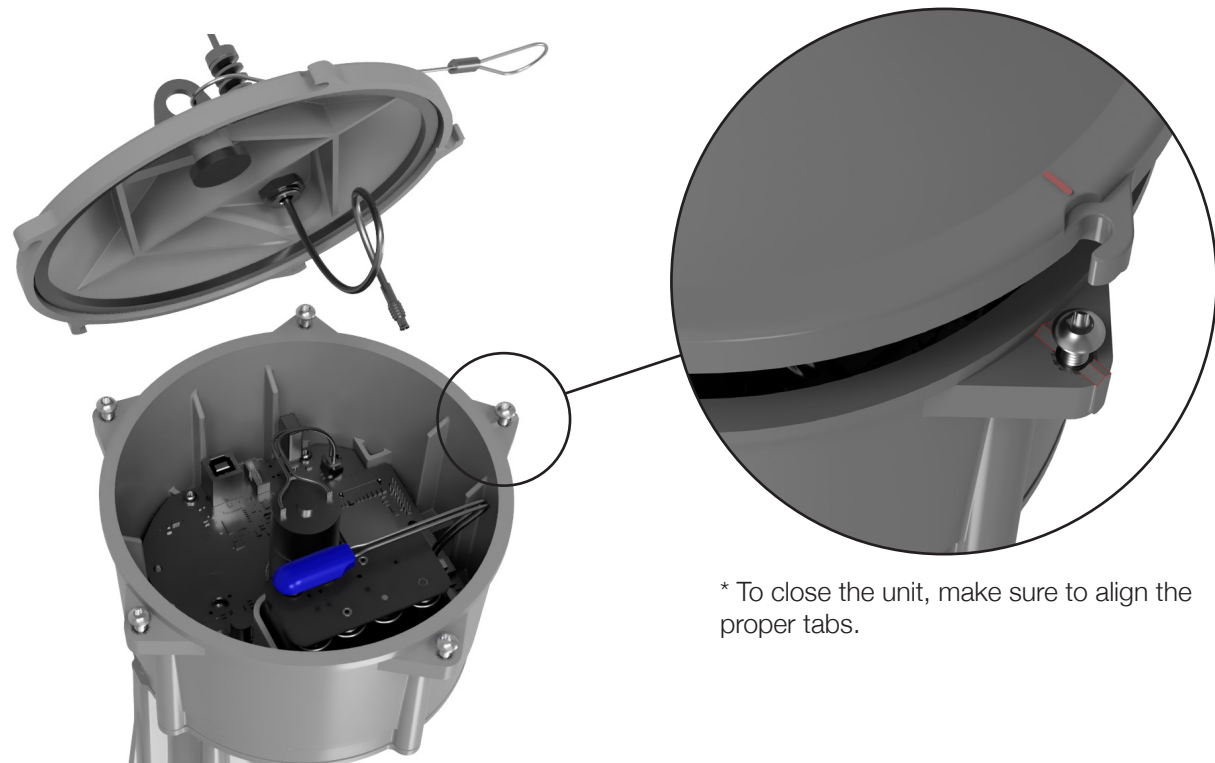

* To close the unit, make sure to align the proper tabs.

3. Device Installation

1. Install the device by inserting the metal clip on the rim's opening, under the seal.
2. Make sure to position the unit on the opposite side of the feed inlet.
3. Put the seal back in place.
4. Close the bin's lid, making sure to position the antenna's wire in a way it won't get damaged. Position the magnetic antenna on a metal surface on the top of the lid or on any metal surface.



Beware! Don't pull on the antenna or antenna's wire during the installation as it can damage it. Make sure that there is enough wire inside the bin to allow a free swing of the device.

4. Bin Registration

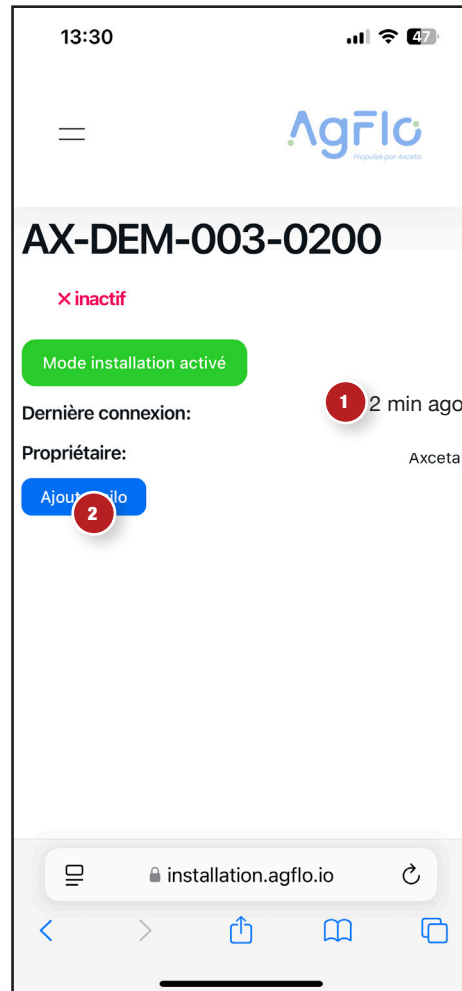

1. Make sure that the device has connected to the network.
2. Click on “Ajouter silo” to start the bin configuration.

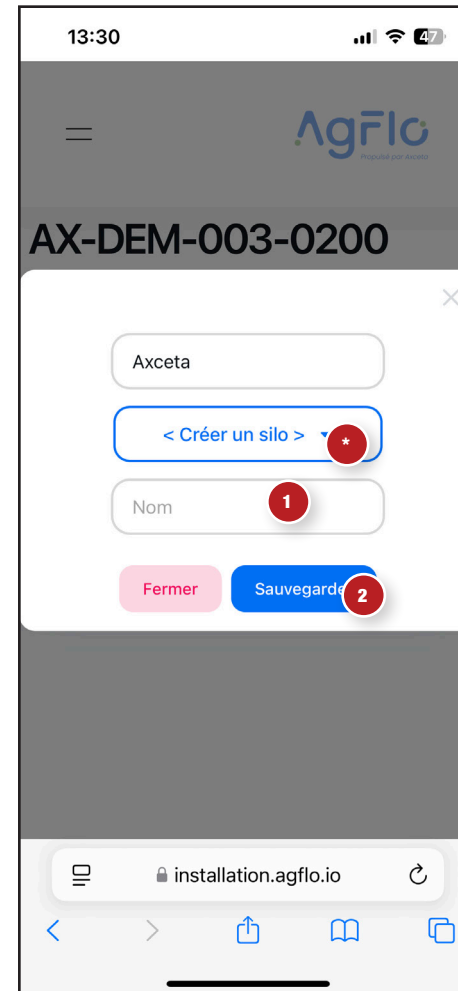

1. Enter a unique ID for the bin. We suggest :
FarmName-Building#-Bin# or
FarmName-BinUniqueID.
2. Click on “Sauvegarder” to save the name.

* If the bin already exists in the system, it will show up in the drop-down list.

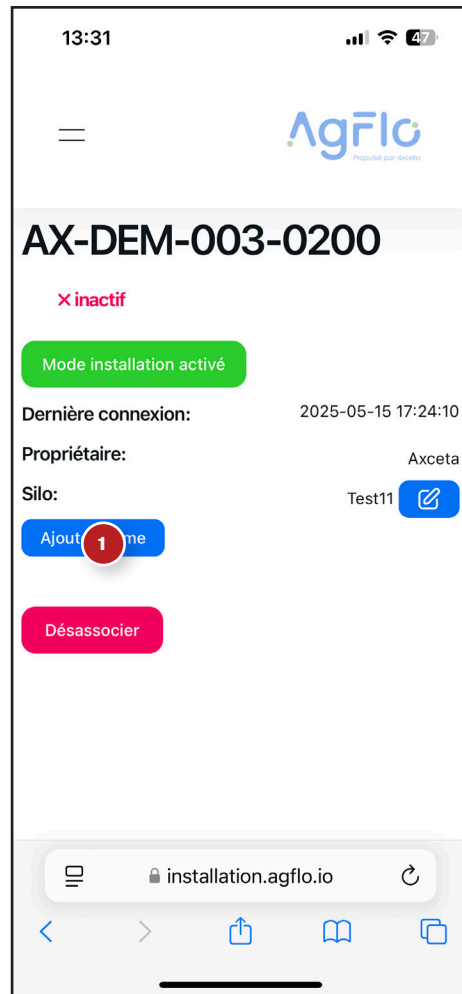

1. Click on “Ajouter ferme” to enter the full name.

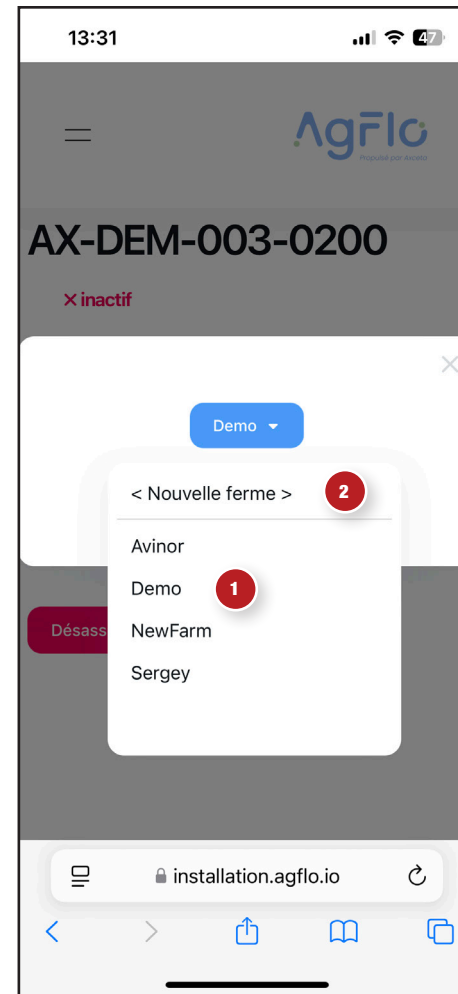

1. If a farm has already been defined for another unit, the farm name will be displayed in the drop-down menu and can be directly selected.
or
2. Enter a new name by selecting “Nouvelle Ferme”.



1. Click on **"Ajouter bâtiment"** to add a building number or ID.

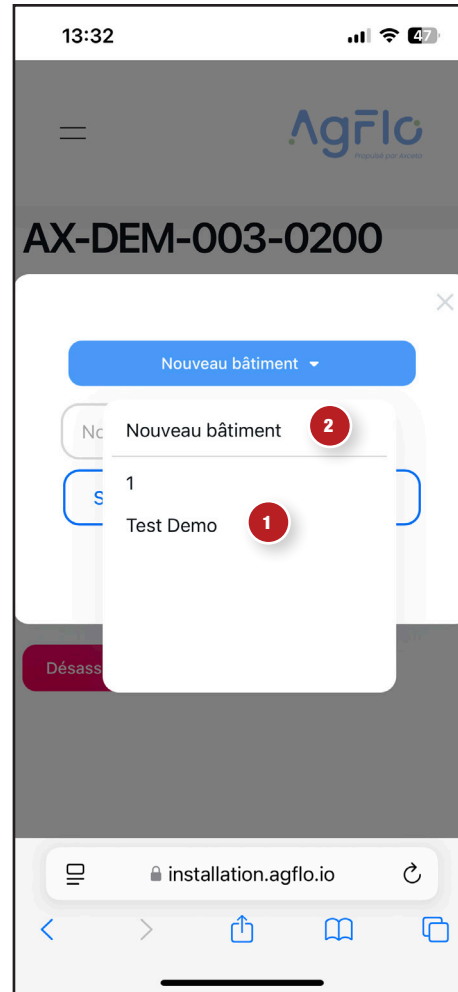

1. If a building has already been defined for another unit, the building name will be displayed in the drop-down menu and can be directly selected.
or
2. Enter a new name by selecting **"Nouveau bâtiment"**.

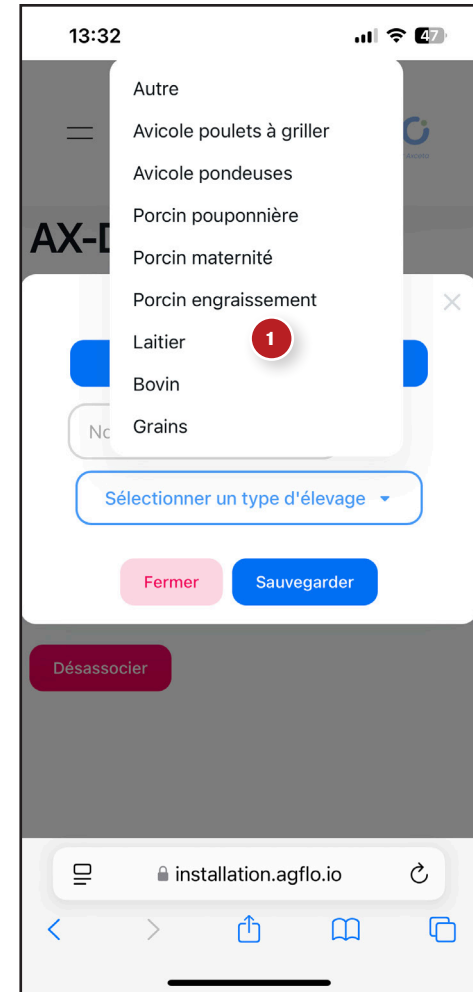

1. Select the type of livestock.
2. Save the information.



1. If the bin is connected to another one (tandem, trio, etc.) and you are registering the second bin, click on “Connecter” to link the bins in the system.
2. Select the connected bin in the drop-down menu.



Add GPS location

3. Click on the icon to locate the bin on the map.

You need to allow the browser to access your location data.



1. Locate the bin on the satellite view and click on the exact location.
2. Click “Sauvegarder” to save the data.

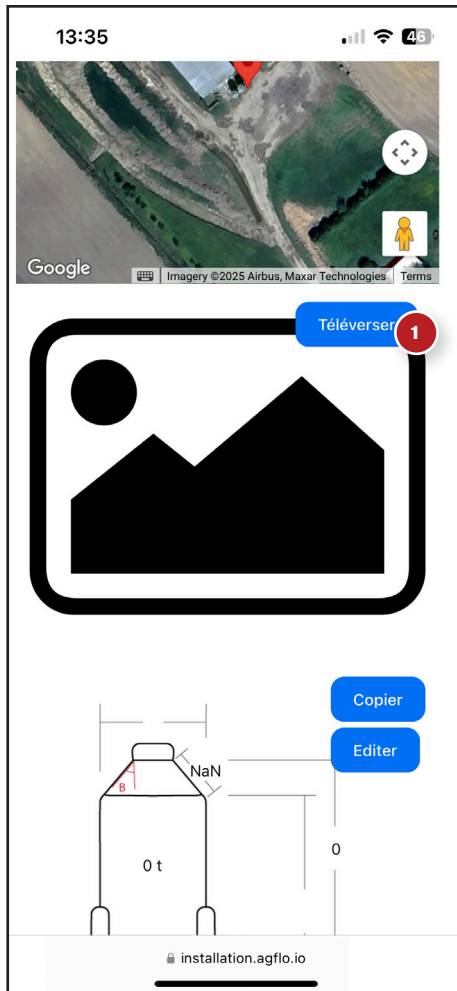

1. Click to add a picture of the bin.

Make sure to capture the full bin from top to bottom.

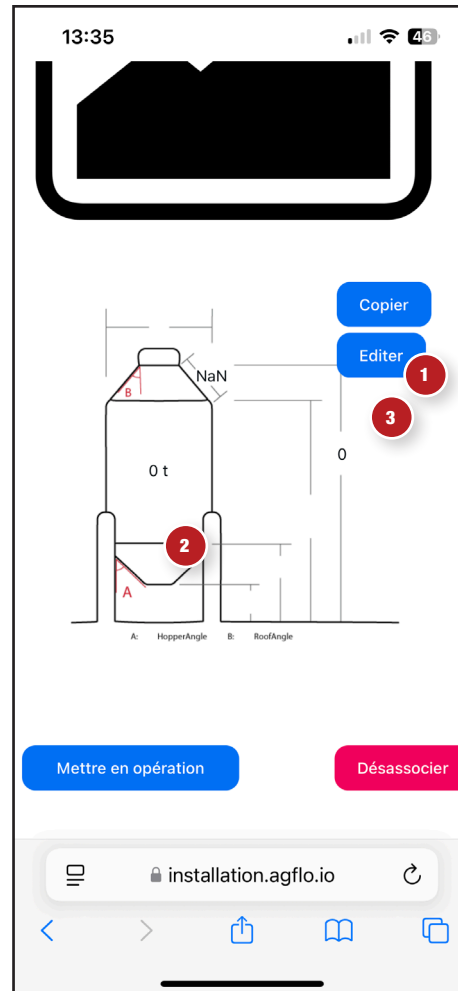

5. Bin Measurement :

1. Click on the button “Éditer”.
2. Enter the dimensions (see section : “Feed bin dimensions”).
3. Click to confirm and save.

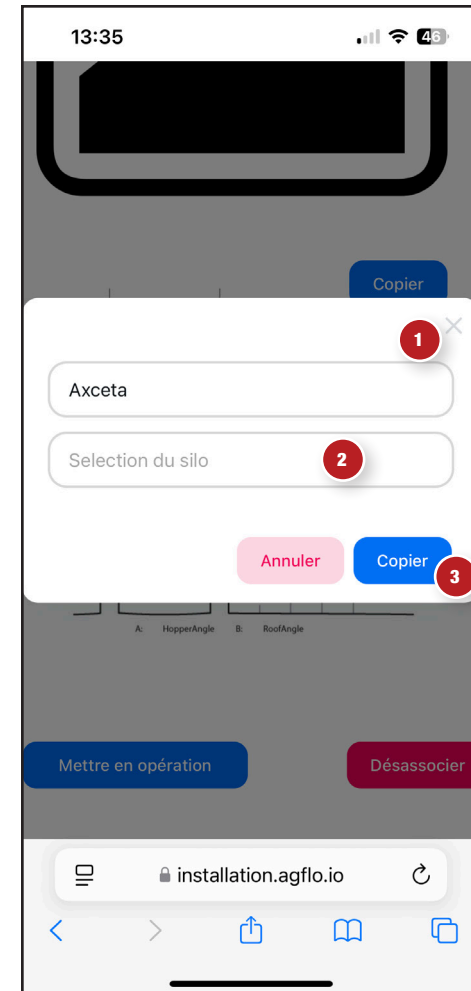

If you already registered an identical bin, you can copy the dimensions by:

1. Click on “Copier”.
2. Enter the first letter of the bin’s ID you want to copy.
3. Select the bin’s name in the drop-down menu and click “Copier”.

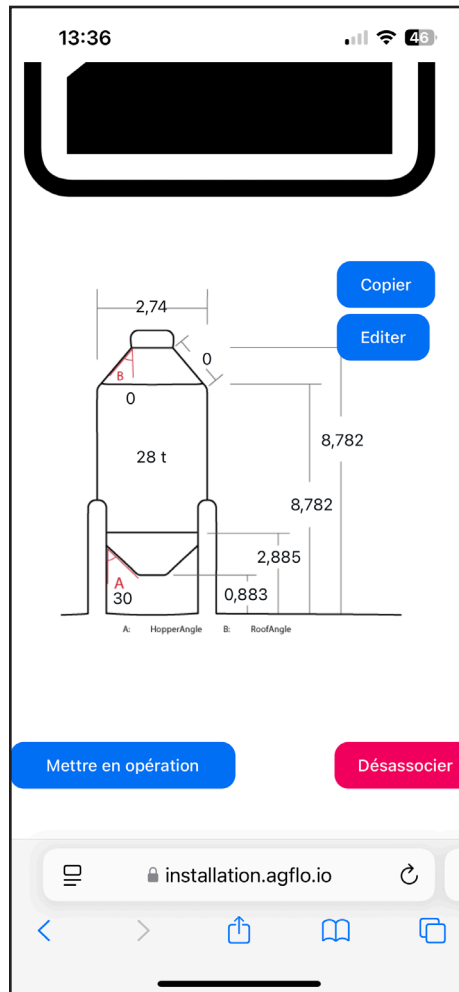

6. Data Validation

1. When all data is entered, click on “*Mettre en opération*” to confirm and start the feed monitoring.
2. If there is an error message, correct the missing information and click “*Mettre en opération*” again.

Make sure to confirm and save the info in each section before clicking “Mettre en opération” .



1. The “*actif*” mention confirms that the sensor has been configured correctly.

The data will show up in the dashboard +/- 12h after the configuration.

Feed Bin Dimensions

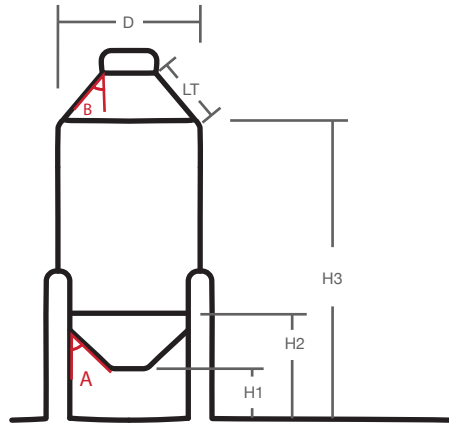

- D : Bin diameter
- LT : Roof length
- H1 : From the ground to the bottom of the bin
- H2 : From the ground to the top of the hopper
- H3 : From the ground to the top of the cylinder
- A : Hopper angle
- B : Roof angle

All dimensions must be input in meters.

All angles must be entered in degrees. They can be easily measured using a smartphone. The 0 degree reference is the vertical.

Bin with central opening.

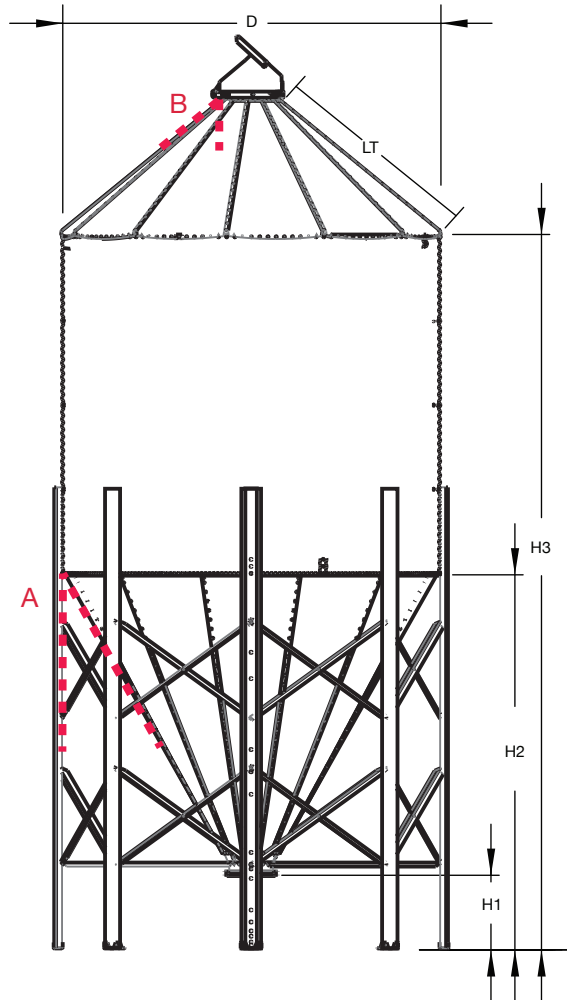

Bin with offset opening

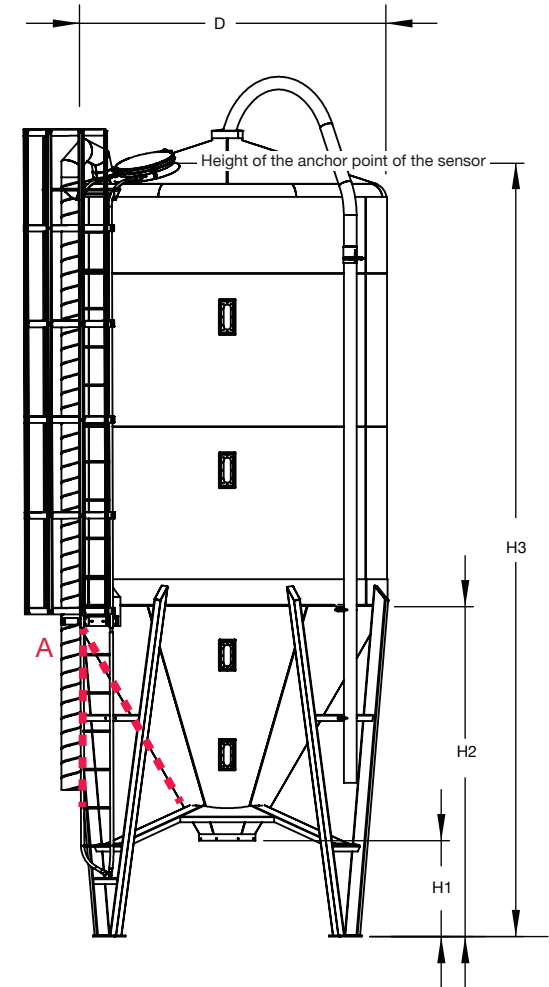

With this configuration, the roof angle should be set to zero and H3 is the measurement from the ground to the point where the clip of the unit is fixed on the rim.

Tips for Bin Measurements

The diameter can be obtained by measuring the distance between opposite legs. Validate this measurement on at least two or three pairs.

Depending on the situation and dimension to be measured, using either a laser distance measurer or a measuring tape will work best.

Be careful! Mistakes in measurements or data inputs will have a significant impact on data accuracy.

Data Visualization

You can access the dashboards at the following address: <https://dashboard.agflo.io>
The username and password will be provided by the AgFlo team.

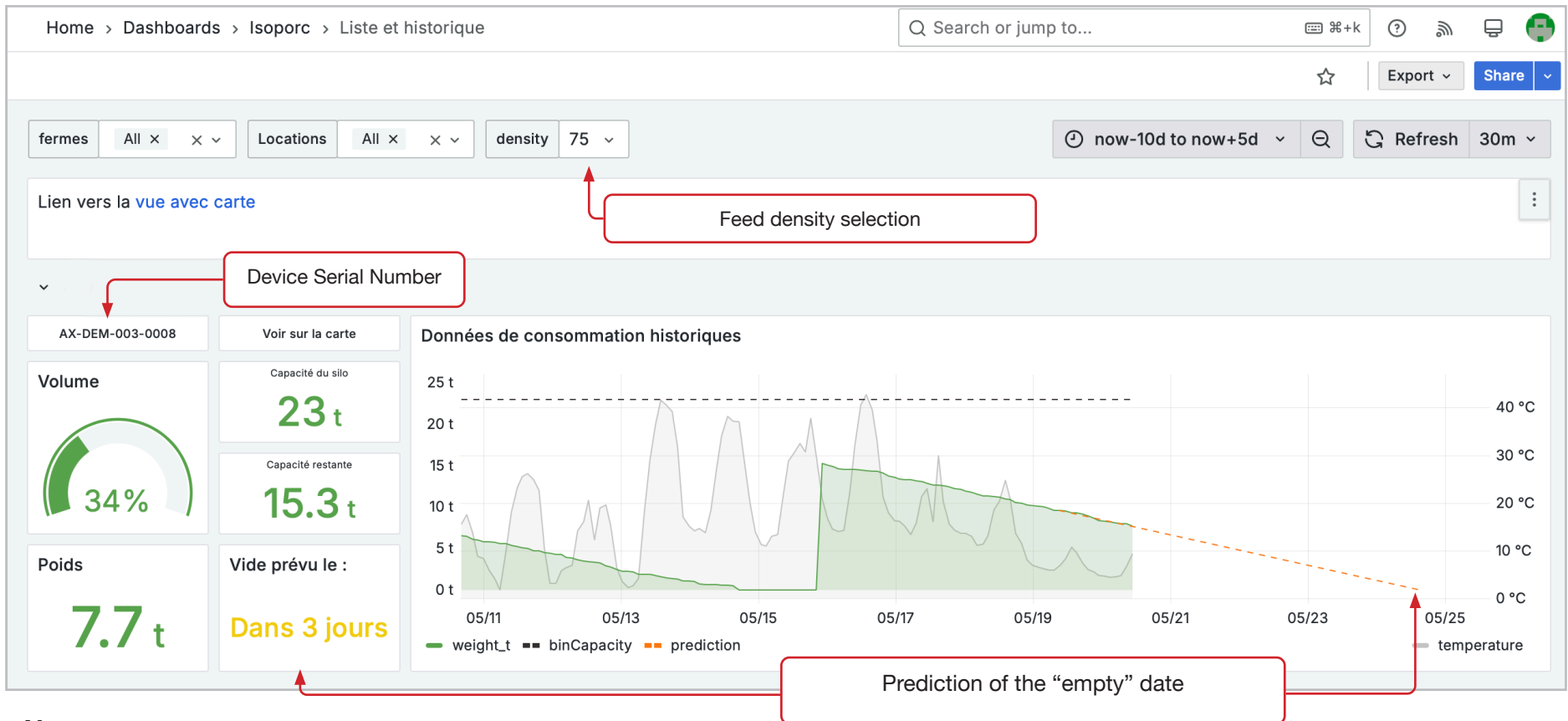

Notes:

- The weight is calculated using an average density. This can be adjusted at the top of the dashboard.
- The prediction is based on the most likely consumption, determined using data from the past 2 to 6 days.
- The meaning of the different predictions is as follows:
 - **Empty:** The silo is already empty or nearly empty
 - **In X hours/days:** Indicates the estimated time until the silo will be empty
 - If the prediction ends with the symbol “~”, the prediction has a higher uncertainty
 - **7+:** The system will not provide predictions beyond 7 days
 - **No consumption:** There is no consumption (e.g., the building is empty) or there is not enough historical data to determine consumption
 - **Unavailable:** The prediction is not available for this silo at the moment (due to missing data or another issue)

Battery Replacement

Required materials:



- 8 AA batteries.
Using lithium batteries is mandatory to keep the sensor working properly
- T20 Torx screwdriver

Procedure:

1. Once the unit is retrieved from the silo, partially unscrew the screws to free the cover and allow it to rotate counterclockwise.
2. Once the unit is open, disconnect the connector (highlighted in blue in the image) from the battery pack and remove the pack.
3. Replace the batteries, reinstall the battery pack in the unit, and reinstall the battery connector.
4. Once the connector is plugged in, you can close the unit and return it to the silo.

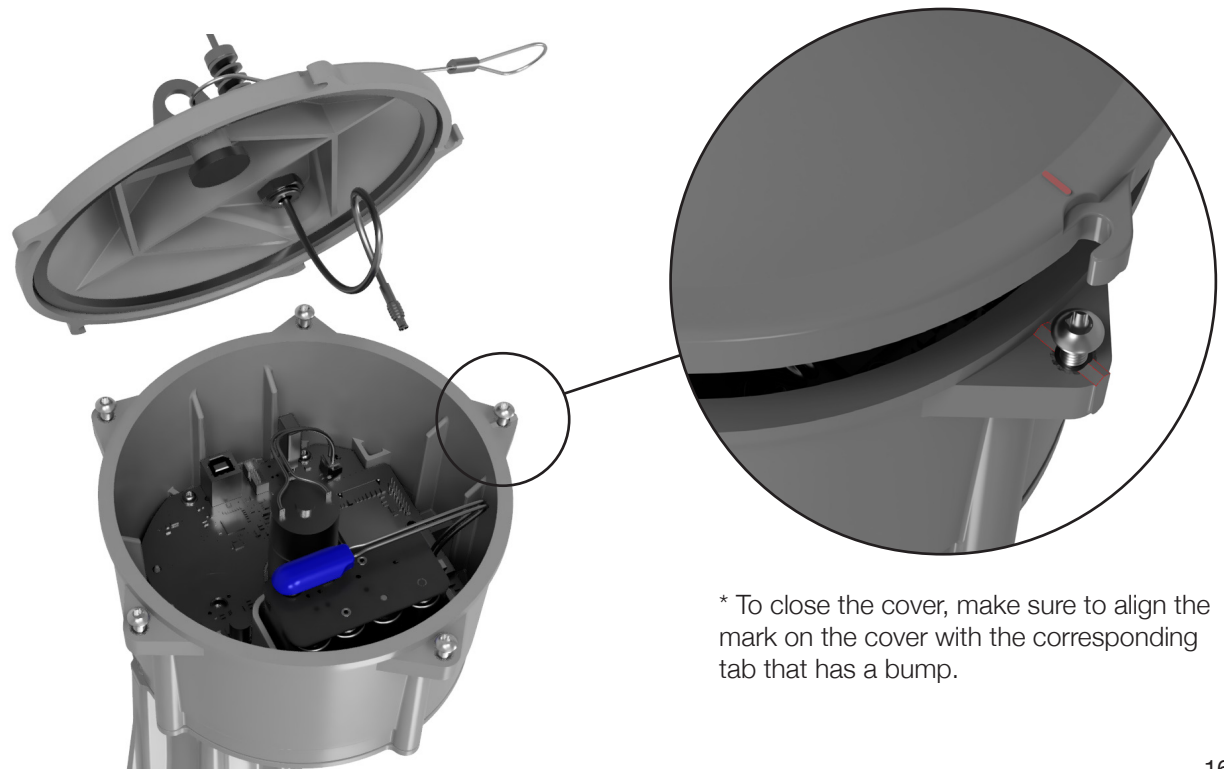
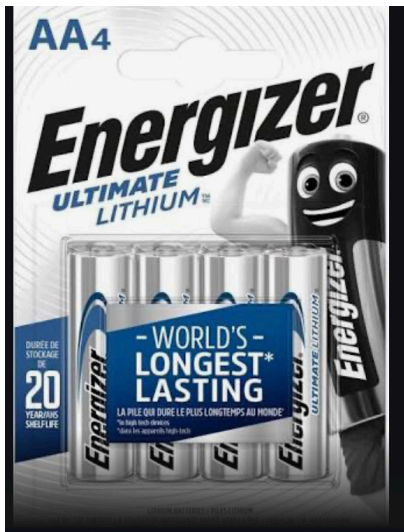

* To close the cover, make sure to align the mark on the cover with the corresponding tab that has a bump.

Device replacement

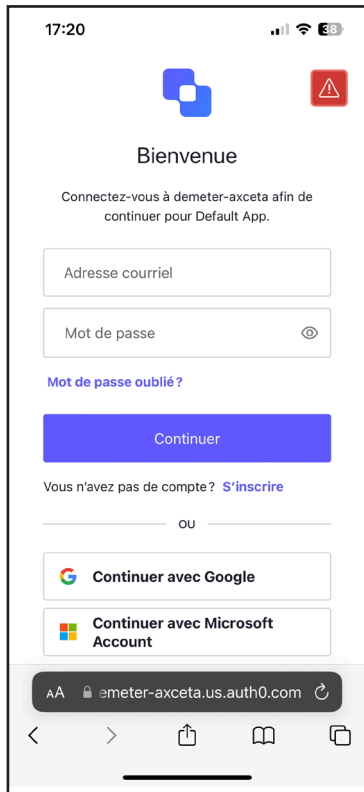

Authentication

1. Authenticate with your credentials.
<https://installation.agflo.io>

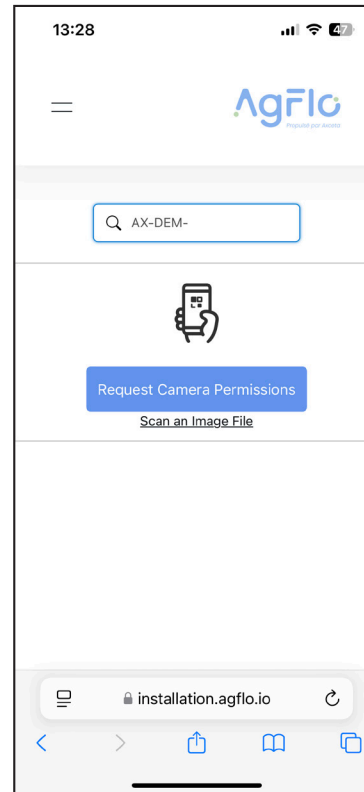

Sensor lookup

1. Scan the installation QR code or enter the serial number of the device you want to remove.

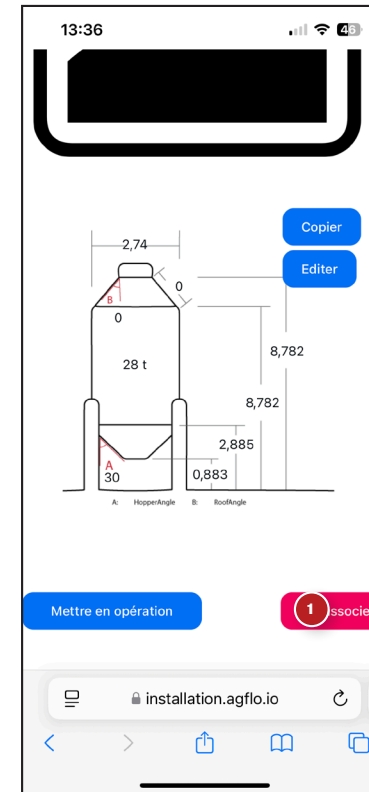

1. Unpair the sensor from the bin by clicking the button "**Desassocier**" at the bottom of the page.

Device replacement

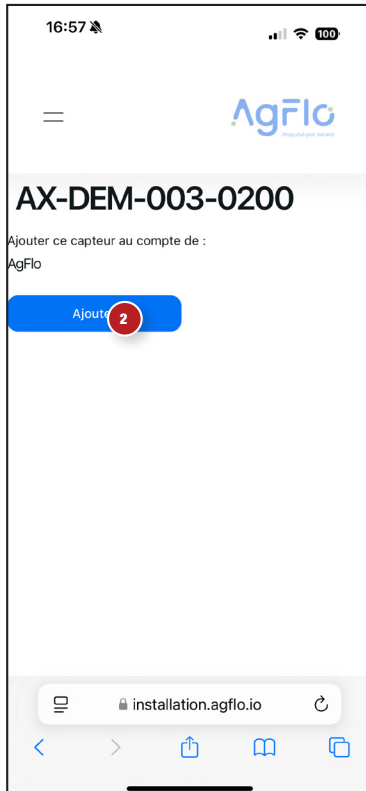

Registering a new device

1. Scan the installation QR code of the new device.
2. Click “Ajouter” to register this device to your account and begin the installation.

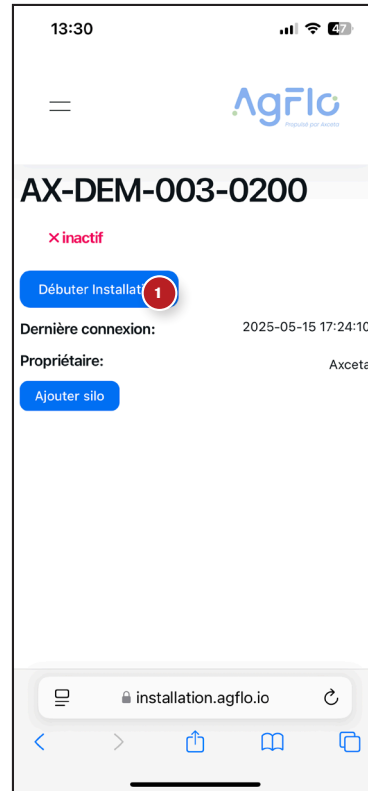

Device installation

1. Click on “Débuter l'installation”.
2. Connect the battery.



1. Validate the time of the last connection to ensure a good cellular connection.
2. If the time doesn't match the moment the battery was connected, try unplugging it, wait 10 seconds, and plug it back in (repeat if needed).



Finalize the configuration

1. Scroll to the bottom of the page and click “Mettre en opération” to complete the configuration.